

PAVE EDGE®

for a perfect edge



PAVE EDGE® STARR/STARRFLEX for drivable surfaces

Impact-resistant and resilient plastic profile made from PVC for the perfect finished edge for pavements made of interlocking stones and pavers, plates, tiles and natural stones. The edges can be completed immediately after laying of the surfaces. No need for concrete works: the pave edge is fixed with nails and can take weight immediately.

PAVE EDGE® STARR

for straight edges



PAVE EDGE® STARRFLEX

for curved edges



PAVE EDGE® STARR/STARRFLEX

Lengths

STARR/STARRFLEX

240 cm

Number of nails required

STARR

3.8 nails/m¹

STARRFLEX

3.8 nails/m¹

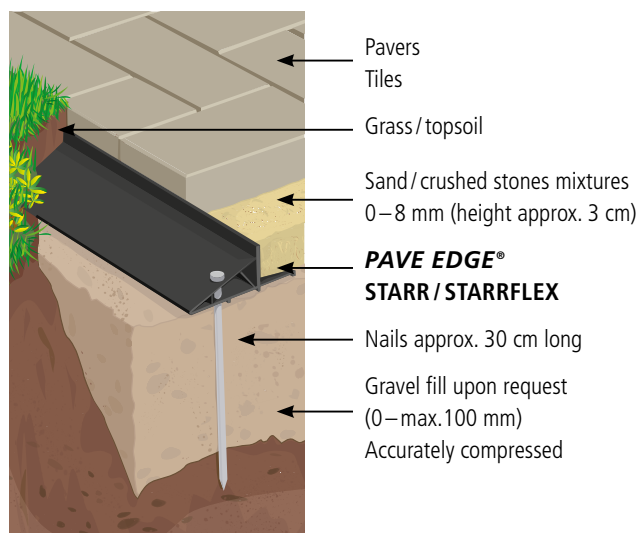
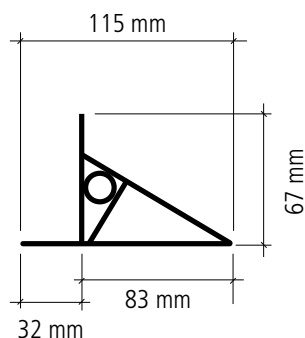

PAVE EDGE® LIGHT / LIGHTFLEX for pedestrian surfaces

These profiles have been developed for use in non-drivable surfaces. In terms of their dimensions, they are considerably smaller and handier. The LIGHT version provides a clean edge for lawn and gravel areas. LIGHTFLEX permits narrow bends. **PAVE EDGE®** and **PAVE EDGE® LIGHT** – the right profile for any edge.

PAVE EDGE® LIGHT

for straight edges



PAVE EDGE® LIGHTFLEX

for curved edges



PAVE EDGE® LIGHT / LIGHTFLEX

Lengths

LIGHT 200 cm

LIGHTFLEX 204 cm

Number of nails required

LIGHT

2 nails / m¹

LIGHTFLEX

2–5 nails / m¹ as required

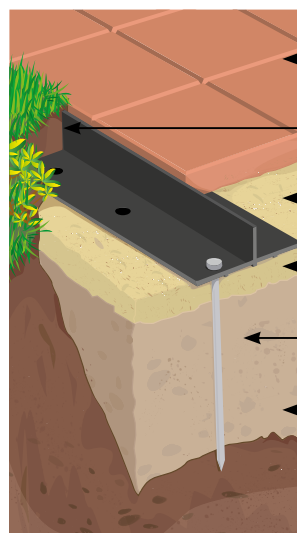
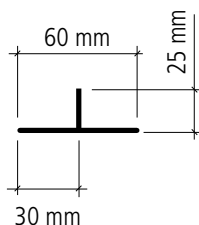

Pavers / tiles
Gravel surfaces

Grass / topsoil

Sand / crushed stones mixtures
0–8 mm (height approx. 3 cm)

**PAVE EDGE®
LIGHT / LIGHTFLEX**

Nails approx. 30 cm long

Gravel fill upon request
(0–max. 100 mm)
Accurately compressed



MÜLLER-STEINAG BAUSTOFF AG is a sales company of the MÜLLER-STEINAG Group.

MÜLLER-STEINAG Group

The owner-operated MÜLLER-STEINAG Group is a self-contained and independent company operating in the areas of concrete goods, pre-fabrication, natural building materials, recycling, waste disposal and water technology. 850 staff spread across thirteen locations in Switzerland guarantee high availability of products for all segments of the building industry.

This is **PAVE EDGE®**

The strong plastic rail **PAVE EDGE®** is number one among edge finish products in Europe and North America. **PAVE EDGE®** is used for both straight and bent edge finishes. Solid and reliable, the rail holds tiles and interlocking stones together both during and after laying of the surface. **PAVE EDGE®** is exclusively distributed in Europe by MÜLLER-STEINAG BAUSTOFF AG.

PAVE EDGE® – simple and easy installation

TOOLS

All you need:
handsaw and hammer.



Using a handsaw, you can easily cut **PAVE EDGE®** to the right length.

SEAMLESS

Optimal transition points thanks to connecting tubes.



Seamless joining of **PAVE EDGE® STARR** and **PAVE EDGE® STARRFLEX** elements using the provided connecting pipes. This does not apply to **PAVE EDGE® LIGHT/LIGHTFLEX**.

INSTALLATION

Installed with nails.
No need for concreting.



Simple fixing of the **PAVE EDGE®** elements with nails.



STRONG

Impact-resistant and resilient plastic profile made from PVC.



Surfaces attached with **PAVE EDGE®** can take weight immediately.